

WINDOWS:		DOORS:		PLUMBING: COLD/HOT WATER		DB BOARD (INTERNAL):		LIGHTS (LED TYPE):		PLUGS:		OTHER:	
900 x 900 ALU T/HUNG	1	SGL CDK DOOR	1			SURFACE MOUNTED	Y	1200 DBL LED	1	1x16a + 1 Euro Sw Soc Outlet	1	PVC WOOD TILES	Y
ALU BURGLAR BARS	Y					EARTH LEAKAGE	Y	EXTERNAL BULKHEAD	1			JACKS & CONCRETE PADS	Y
						220V	Y	LIGHT SWITCH - 1L1W	1			STEPS - SINGLE DOOR/DOUBLE TIER	1
								DAY/NIGHT SWITCH	1				

NOTE:

- POLYSTYRENE PANELS - 40mm EPS CORE;
- FLOOR TO EAVES CEILING HEIGHT: 2.4m;
- COLOUR OF TRIM:BLACK;
- ALL VISIBLE INSIDE STEEL TO BE PAINTED WHITE;
- **MOBILE**
- ALL LOOSE FURNITURE EXCLUDED UNLESS OTHERWISE STATED ON DRAWING LEGEND OR QUOTATION
- D/B BOARD 1700mm INSTALLED FROM GROUND (UON)
- PLUGS 400mm INSTALLED FROM GROUND (UON)
- LIGHT SWITCH 1300mm INSTALLED FROM GROUND (UON)
-

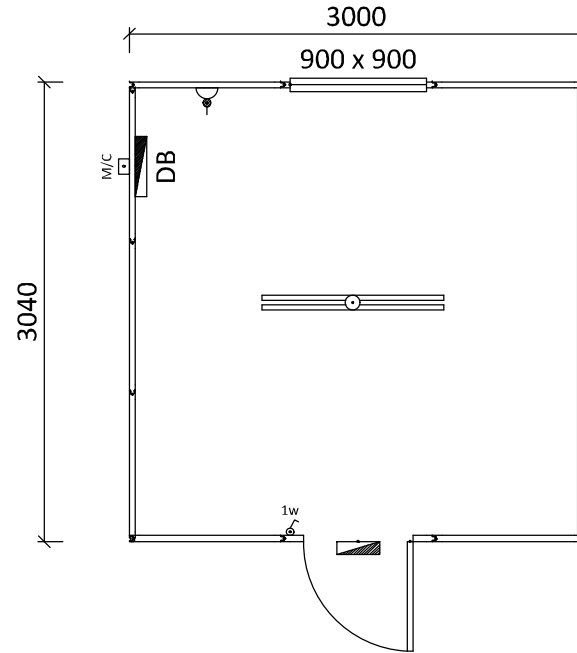

DATE	DESCRIPTION	REV.	INT.
28/03/2022	GENERAL LAYOUT	0	AG
28/03/2022	TITLE BLOCK UPDATED - FINAL RELEASE	1	AG

ONLY 1 APPROVAL REQUIRED

ORIGINATOR	ARNO GOUWS	DATE	
SIGNATURE		28/03/2022	
APPROVED	EDUARD BOTHMA	DATE	
SIGNATURE			
APPROVED	KP DIPPENAAR	DATE	
SIGNATURE			

DRAWING SCALE:	1:50
DRAWING SHEET:	A4
DRAWING REV:	0

DRAWING NO	
A	ABP 0
WO	
EST	

TITLE	
CLIENT:	
DESCRIPTION:	3 x 3 OPEN PLAN



160 Main Street,
 Corner Bon Cretion Street,
 Pomona AH, Kempton Park
 P.O. Box 619, Isando 1600
 Tel (011) 397 - 8150
 Fax (011) 397 - 8155
 E-mail: sales@abacusspace.co.za